



## eBell Linux embedded Hybrid DVR series Hybrid-xxxx-URxx

### Hybrid DVR Software Features

#### ▶ Monitoring

- Linux OS, MPEG-4 to Analog and H.264 to IP Cam.
- Max analog 16 cameras, 16 IP cameras ( Model No. EVP16-48 ).
- Support 2 monitors, one for Live, another for Playback.
- Support channel new layout, by pulling any channel to desired position.
- Analog cameras: NTSC : 352 X 240, 720 X 240(HD1), 720 X 480(D1).  
PAL : 352 X288,720X288(HD1),720X576(D1).
- Analog image in CIF, Half D1, D1 resolutions, 16 Ch system total FPS 600 in CIF.
- IP cam resolution: depending on each IP camera.
- Monitor resolution:1280X768
- Live display: 1, 4, 6, 7, 10, 13, 16, 17, 36, 49, 64divisions and full screen display.
- When event occurs, or scene changed corresponding Channel will flash for attention.
- Frame size and FPS data in Playback pictures.
- E-Map of multi-layer may add new cameras and display video on map.
- Internet user max 10 , may set, download video data of DVRs in remote.
- Password / Multi-user management.
- System log: Log in/out, user information and its IP address.
- On screen IO device management.
- On screen PTZ control panel.
- HD information and calculation of recording time.
- Digital signature.



Hybrid-xxxx-UR00  
(4U, No Inner RAID)



Hybrid-xxxx-UR03  
(4U, Inner RAID 3 Bay)

#### ▶ Recording

- IP camera FPS max 30 f/s(NTSC), 25f/s(PAL), depending on each IP cam.
- Recording mode: view only/ continuous/Motion/ Alarm/Motion & Alarm/ Mixed mode.
- FPS and parameters of each camera can be set respectively.
- Event pre recording 5~30, Post recording 10~120.
- File length: 5 , 10, 15 min.
- May recording both at server and in remote.

#### ▶ Audio

- Analog Camera, Audio each Ch.; IP cam, Audio depending on IP cam spec

#### ▶ Back up

- CD-RW,DVD-RW,RAID,NAS
- USB1.1 / 2.0

#### ▶ Smart Search & Easy Playback

- Digital zoom for single picture and motion picture.
- Snapshot and storage for single and multiple pictures.
- Support multi-channel time synchronized or not synchronized playback.



Hybrid-xxxx-UR06  
(4U, Inner RAID 6 Bay)



- Support single channel playback of different time intervals.
- Support video and audio synchronized playback.
- Support event type and time search.
- Support sec/min/hr picture preview, and to export or start playback by clicking picture of interest.
- Support single and multiple channels backup.



▶ **Alarm and Notification**

- Each camera can connect to any or all the sensors and select one or all different notifications.
- Event types: Video loss, Sensor triggered, Motion detection triggered.
- Alert notifications: Video loss, Sensor triggered, HD crushed, System crushed.
- Auto pop-up on e-Map when event occurred.
- Motion detection: 15 x 22 small blocks to set alarm area.
- Support multiple Internet I/O devices.



▶ **Mobile Phone Application**

- Support 3G RTSP, and no new download required.

▶ **Video Analytics (Optional)**

- Object left (object in).
- Object removal (object out).
- Flow count.



▶ **Networking and System**

- Support TCP/IP, PPPoE, DHCP, DDNS.
- Support NTP server.
- System log: system on/off, video loss, GUI, PTZ, schedule, Device manager.
- Support USB firmware upgrade.

▶ **CMS**

- CMS can manage all eBell DVR, Hybrid DVR, NVR systems.
- Any eBell Hybrid DVR can be promoted as CMS Server.
- Support multi monitors and e-Map.

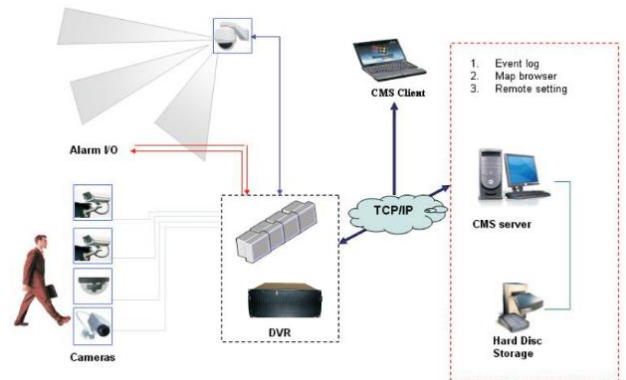



## Hardware Specification



**Hybrid-xxxx-UR00**  
(4U, No Inner RAID)

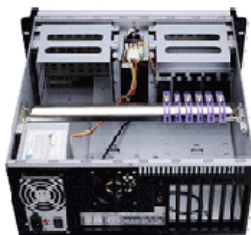

**Hybrid-xxxx-UR03**  
(4U, Inner RAID 3 Bay)



**Hybrid-xxxx-UR06**  
(4U, Inner RAID 6 Bay)

<b>Chipset</b>	Intel® Q35 + ICH9DO Chipset
<b>CPU</b>	<ul style="list-style-type: none"> <li>• Single LGA775 Socket</li> <li>• Supports Intel® Core™2 Extreme QX9000/QX6000 series</li> <li>• Supports Intel® Core™2 Quad Q9000/Q8000/Q6000 series</li> <li>• Supports Intel® Core™2 Duo E8000/E7000/E6000/E5000 series</li> </ul>
<b>Memory Type</b>	DDR2 800/667MHz un-buffered, non-ECC SDRAM.
<b>Audio</b>	High Definition 5.1 Channel Audio
<b>Networking Controller</b>	Gigabit LAN Port
<b>PCI-E Slots</b>	1(x1) PCI-e slot 5x 32-bit PCI slots
<b>USB</b>	12x USB 2.0 / 1.1 compatible 6 rear + 2 Type A connectors + 2 headers ( 4 ports )
<b>SAS Controller</b>	ACS-76200
<b>RAID</b>	RAID 0 、 1 、 5 support
<b>Power Supply</b>	<ul style="list-style-type: none"> <li>• 400W (No Inner RAID)</li> <li>• 500W (Inner RAID 3 Bay)</li> <li>• 700W (Inner RAID 6 Bay)</li> </ul>
<b>Dimensions</b>	<b>4U</b> : 178 (H) x 482 (W) x 528 (D) mm



## Hybrid DVR Full Model List

### Product Coding



Hybrid-xxxx-UR00    Hybrid-xxxx-UR03    Hybrid-xxxx-UR06

<b>Product Selection</b>	<b>Channel Selection</b>	<b>Hardware Selection</b>	
Hybrid	xx xx	U R 00	None inner RAID
		03	Single inner RAID : 3 Bay
		06	Double inner RAID : 6 Bay
			Inner RAID
			4U Rackmount Case
			Digital Channel Number
			Analog Channel Number

Item	Model Code	Case + Power	Main board	CPU	RAM 2G/ 4G	DOM	Inner RAID	RAID Card
1	Hybrid-1600-UR00	4U + 400W	Industrial	Quad	DDR2 2G *2	512M	N	N
2	Hybrid-1600-UR03	4U + 500W	Industrial	Quad	DDR2 2G *2	512M	Inner Raid 3X*1	N
3	Hybrid-1600-UR06	4U + 700W	Industrial	Quad	DDR2 2G *2	512M	Inner Raid 3X*2	N
4	Hybrid-2400-UR00	4U + 400W	Industrial	Quad	DDR2 2G *2	512M	N	N
5	Hybrid-2400-UR03	4U + 500W	Industrial	Quad	DDR2 2G *2	512M	Inner Raid 3X*1	N
6	Hybrid-2400-UR06	4U + 700W	Industrial	Quad	DDR2 2G *2	512M	Inner Raid 3X*2	N
7	Hybrid-3200-UR00	4U + 400W	Industrial	Quad	DDR2 2G *2	512M	N	N
8	Hybrid-3200-UR03	4U + 500W	Industrial	Quad	DDR2 2G *2	512M	Inner Raid 3X*1	N
9	Hybrid-3200-UR06	4U + 700W	Industrial	Quad	DDR2 2G *2	512M	Inner Raid 3X*2	N